

MEMORIAL SLIDE  
 TUB = 0.181445  
 ZWB = 0.238630  
 FACE = 1.016880  
 DEVELOP = 1.020111  
 BLANK SLIDE  
 TUB = 0.181443  
 ZWB = 1.016882

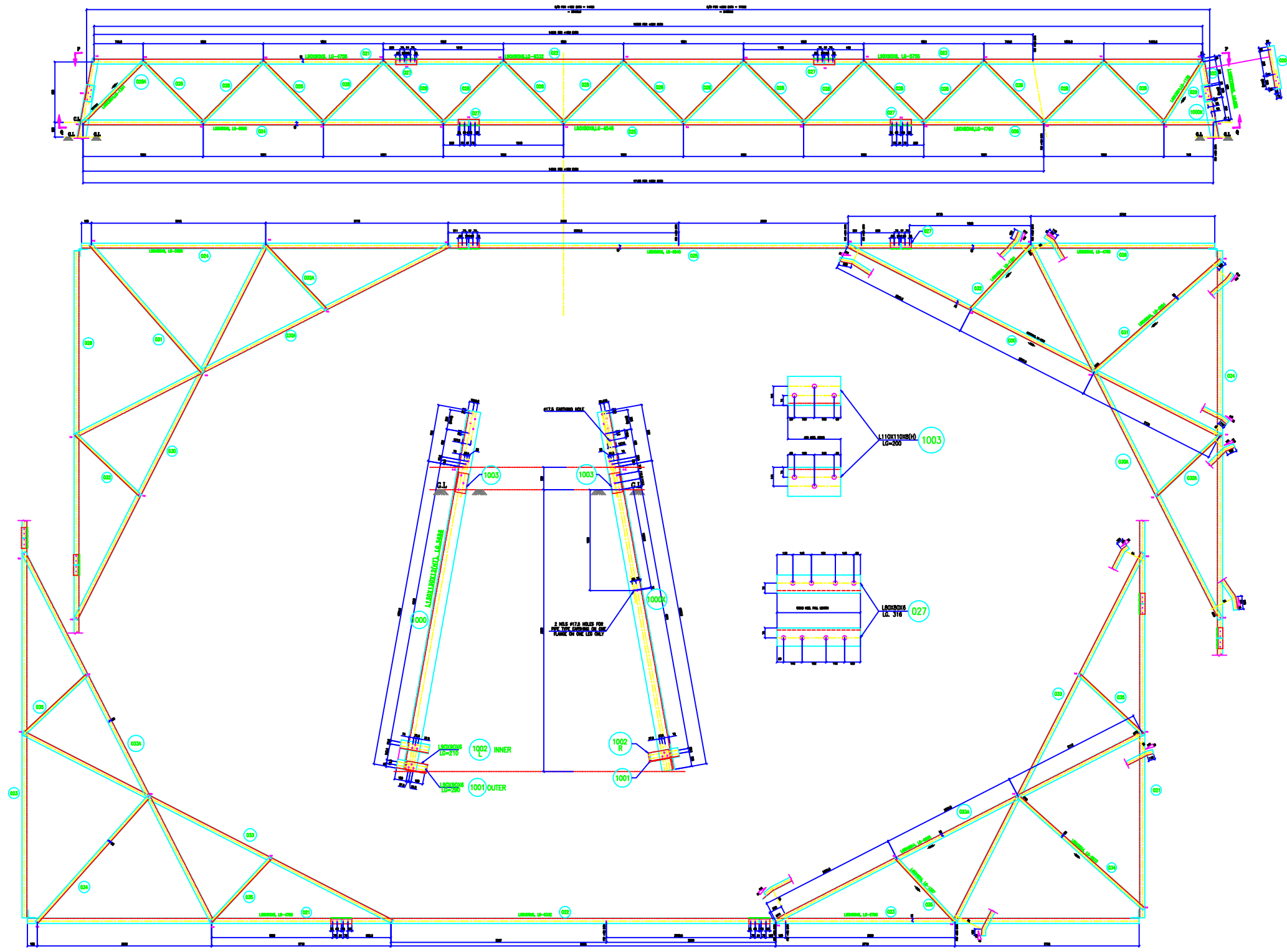
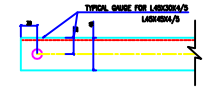

BOLTS AND NUTS STATEMENT

TYPE	SIZE (IN MM)	QUANTITY	
		STUB	TEMPLATE
B	# 16X35	-	172
C	# 16X40	-	100
D	# 16X45	24	44
E	# 16X50	36	4
F	# 16X55	-	-
G	# 16X60	-	-
H	# 16X65	-	-
J	# 16X70	-	-
K	# 16X75	-	-
L	# 16X80	-	-
SPRING WASHERS		60	320
30 OLD PACKING WASHERS # 17.5 MM			
	5 mm	-	-
	6 mm	-	-
	8 mm	-	-
	10 mm	-	-
STEP BOLTS #16 mm X 175mm		-	-

- GENERAL NOTES:
- ALL DIMENSIONS ARE IN MM UNLESS OTHERWISE SPECIFIED.
  - MILD STEEL BOLT AND NUTS TO BRASS/1042/10.9 QUALITY
  - ALL MILD STEEL BOLT AND NUTS ARE TO BE HOT DIP GALVANIZED AS PER ASTM A153
  - ALL MILD STEEL SECTIONS SHALL BE OF TESTED QUALITY CONFORMING TO IS 2062 STANDARD
  - GALVANIZATION OF TOWER MEMBERS AND FLAT WASHERS AS PER IS 2069
  - ALL HOLES # 13.5mm FOR #12mm BOLTS
  - ALL HOLES # 17.5mm FOR #16mm BOLTS
  - ALL HOLES # 21.5mm FOR #20mm BOLTS
  - ALL HOLES # 17.5mm FOR #18mm STEP BOLTS
  - STANDARD SPRING WASHERS ARE TO BE USED UNDER EACH NUT
  - ALL FABRICATED MEMBERS SHALL HAVE PREPARED
  - MEMBERS MEMBERS BEING USED AS STEP BOLTS
  - STEP BOLTS ARE TO BE PROVIDED ON TWO OPPOSITELY OPP. LEGS

MARK NO: 020-035, 1000-1003

BIHAR STATE POWER TRANSMISSION COMPANY LTD

DRAWN BY		DESCRIPTION	132KV D/C TOWER TYPE "DD" STUB & ADJUSTABLE TEMPLATE FOR +18M & +25M EXTN	SCALE	-
CHECKED BY		DRG NO	132KV-D/C-Struct-Stub-Temp-+18M -+25M-Extn-413	SHEET NO	1-1
APPROVED BY				REV.	0