

VERTICAL SCALE

THW = 0.00001
 THM = 0.00002
 FACE = 1.01000
 DEVELOP = 1.03000

HORIZONTAL SCALE

THW = 0.10000
 THM = 1.01000

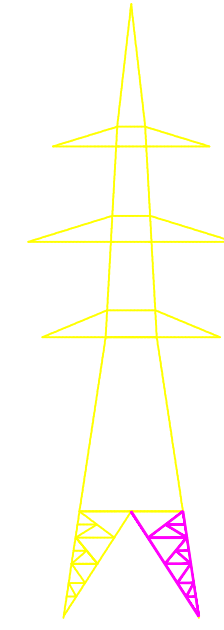
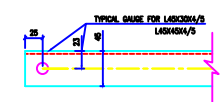
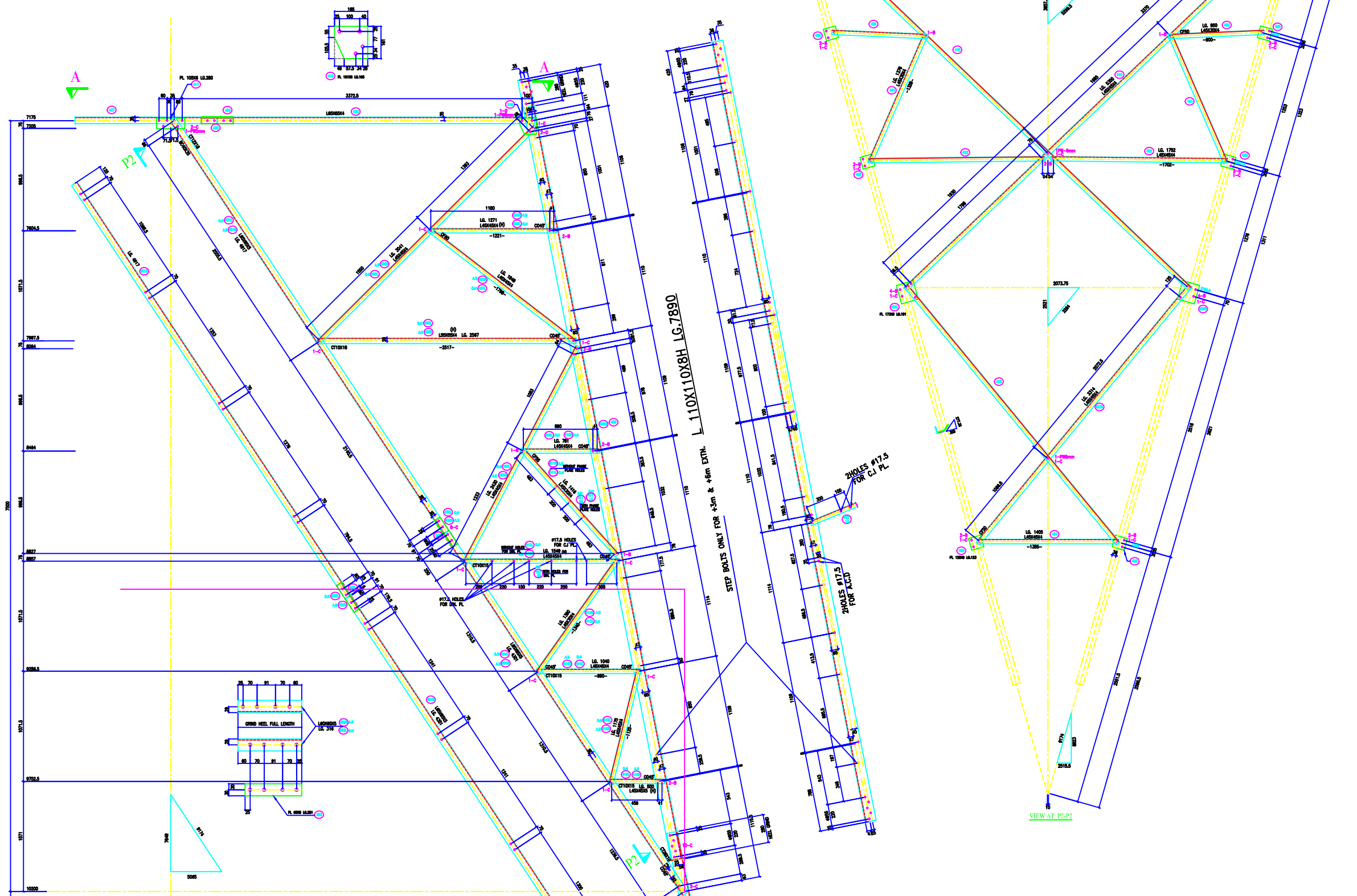

BOLTS AND NUTS STATEMENT

TYPE	SIZE (H MM)	QUANTITY
B	# 16X35	200
C	# 16X40	248
D	# 16X45	16
E	# 16X50	8
F	# 16X55	-
G	# 16X60	-
H	# 16X65	-
J	# 16X70	-
K	# 16X75	-
L	# 16X80	-
SPRING WASHERS		472
30 O.D PACKING WASHERS # 17.5 MM		
5 mm		8
6 mm		8
8 mm		8
10 mm		-
STEP BOLTS #16 mm X 175mm		12

- GENERAL NOTES:**
1. ALL DIMENSIONS ARE IN MM UNLESS OTHERWISE SPECIFIED.
 2. MILD STEEL BOLT AND NUTS TO IS 4026/15437/5.8 QTY
 3. ALL MILD STEEL BOLT AND NUTS ARE TO BE HOT DIP GALVANIZED AS PER ASTM A153
 4. ALL MILD STEEL SECTIONS SHALL BE OF TESTED QUALITY CONFORMING TO IS 2008 STANDARD
 5. GALVANIZATION OF TOWER MEMBERS AND FLAT WASHERS AS PER IS 2009
 6. ALL HOLES # 16.5mm FOR #16mm BOLTS
 7. ALL HOLES # 17.5mm FOR #17.5mm BOLTS
 8. ALL HOLES # 21.5mm FOR #20mm BOLTS
 9. ALL HOLES # 17.5mm FOR #16mm STEP BOLTS
 10. STANDARD SPRING WASHERS ARE TO BE USED UNDER EACH NUT
 11. ALL FABRICATED MEMBERS SHALL HAVE PROFS
 12. @ INDICATES MEMBERS BEING USED AS STEP BOLTS.
 13. STEP BOLTS ARE TO BE PROVIDED ON TWO DIAGONALLY OPP. LEGS

MARK NO: 400 + 426

BIHAR STATE POWER TRANSMISSION COMPANY LTD

DRAWN BY		DESCRIPTION	220KV D/C TOWER TYPE "2DB" DETAIL OF ±0 BASE	SCALE	-
CHECKED BY		DRG NO	220KV-D/C-Struct-±0M -Base-22	SHEET NO	1-1
APPROVED BY				REV.	0