

VERTICAL SCALE  
 1MM = 0.25000  
 2MM = 0.50000  
 FACE = 1.00000  
 DEVELOP = 1.00000  
 HORIZONTAL SCALE  
 1MM = 0.328197  
 2MM = 1.027796

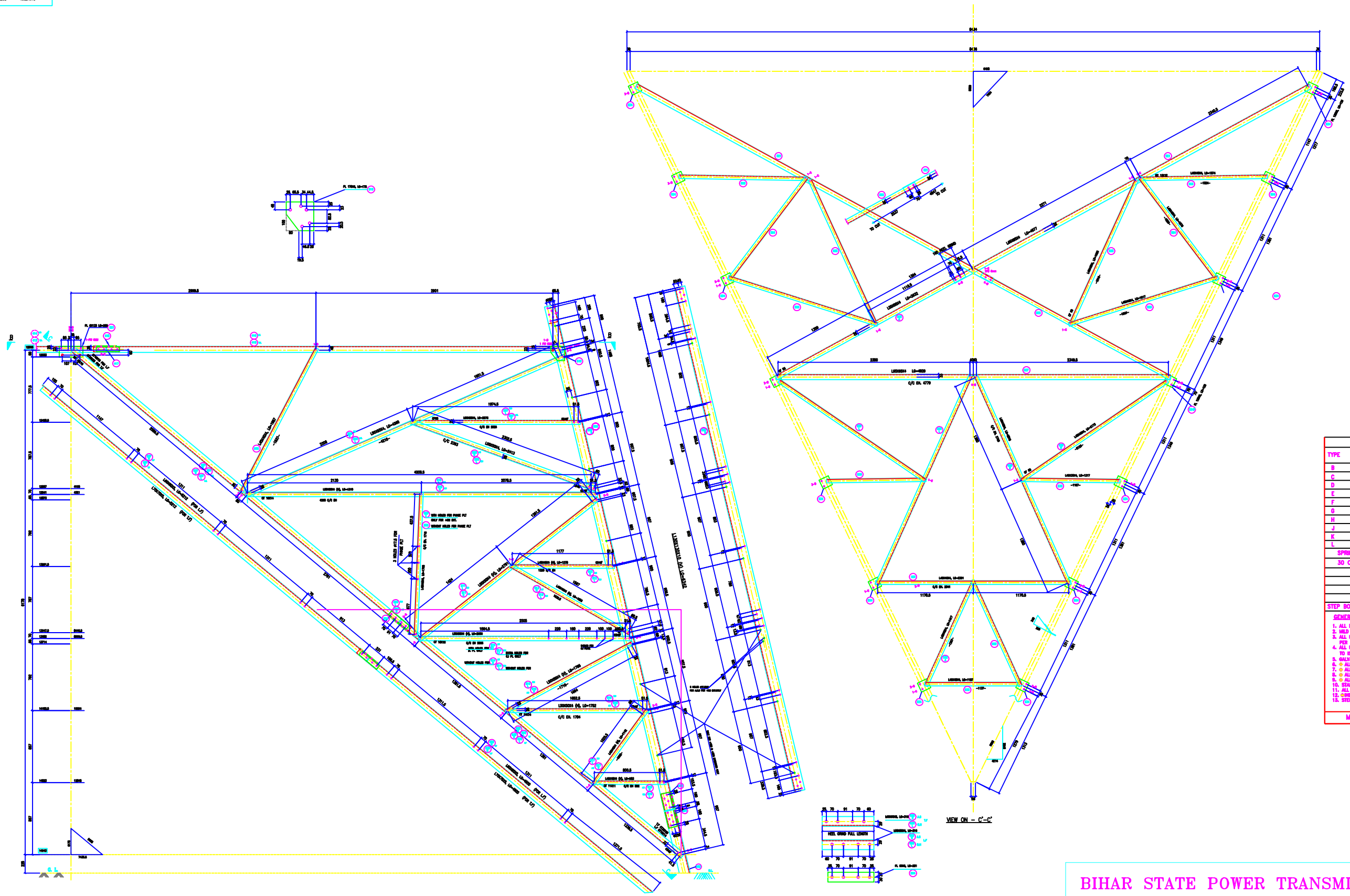
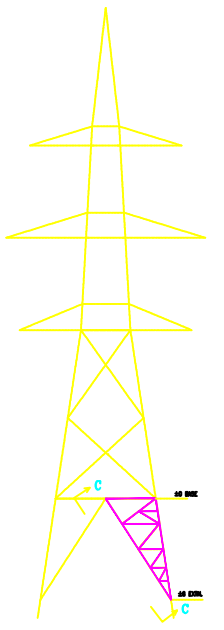
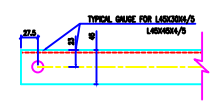

**BOLTS AND NUTS STATEMENT**

TYPE	SIZE (IN MM)	QUANTITY	TOTAL
B	# 16X55	232	242
C	# 16X40	544	398
D	# 16X45	40	44
E	# 16X50	88	96
F	# 16X55	-	-
G	# 16X60	-	-
H	# 16X65	-	-
J	# 16X70	-	-
K	# 16X75	-	-
L	# 16X80	-	-
SPRING WASHERS		712	770
30 O.D. PACKING WASHERS # 17.5 MM			
5 mm		16	
6 mm		-	
8 mm		-	
10 mm		8	
STEP BOLTS #16 mm X 175mm		15	

- GENERAL NOTES:**
1. ALL DIMENSIONS ARE IN MM UNLESS OTHERWISE SPECIFIED.
  2. WELD STEEL BOLT AND NUTS TO 2082B/23427/3.6 ONLY
  3. ALL WELD STEEL BOLT AND NUTS ARE TO BE HOT DIP GALVANIZED AS PER ASTM A153
  4. ALL WELD STEEL SECTIONS SHALL BE OF TESTED QUALITY CONFORMING TO IS 2002 STANDARD
  5. GALVANIZATION OF TOWER MEMBERS AND PLAT WASHERS AS PER IS 2002
  6. ALL HOLES # 15.5mm FOR #16mm BOLTS
  7. ALL HOLES # 17.5mm FOR #18mm BOLTS
  8. ALL HOLES # 21.5mm FOR #20mm BOLTS
  9. ALL HOLES # 27.5mm FOR #24mm STEP BOLTS
  10. STANDARD SPRING WASHERS ARE TO BE USED UNDER EACH NUT
  11. ALL FABRICATED MEMBERS SHALL HAVE PROTECTIVE COATING
  12. @ INDICATES MEMBERS BEING USED AS STEP BOLTS
  13. STEP BOLTS ARE TO BE PROVIDED ON TWO DIAGONALLY OPP. LEGS

MARK NO: 500 + 538

**BIHAR STATE POWER TRANSMISSION COMPANY LTD**

DRAWN BY		DESCRIPTION	220KV D/C TOWER TYPE "2DD" +6M EXTN WITH VIEW "C-C"	SCALE	-
CHECKED BY		DRG NO	220KV-D/C-Struct.+6M-Extn -410	SHEET NO	1-1
APPROVED BY				REV.	0