

VERTICAL SCALE
 1MM = 0.000703
 2MM = 0.134148
 FACE = 1.000484
 DEVELOP =

MARK NO.
 1MM = 0.000025
 2MM = 1.000254

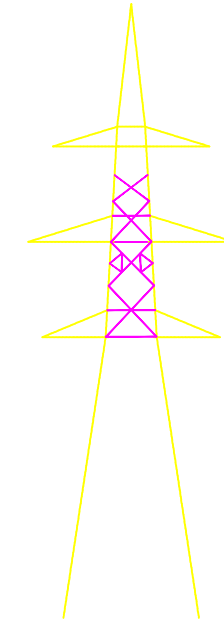
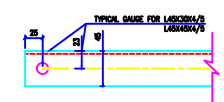
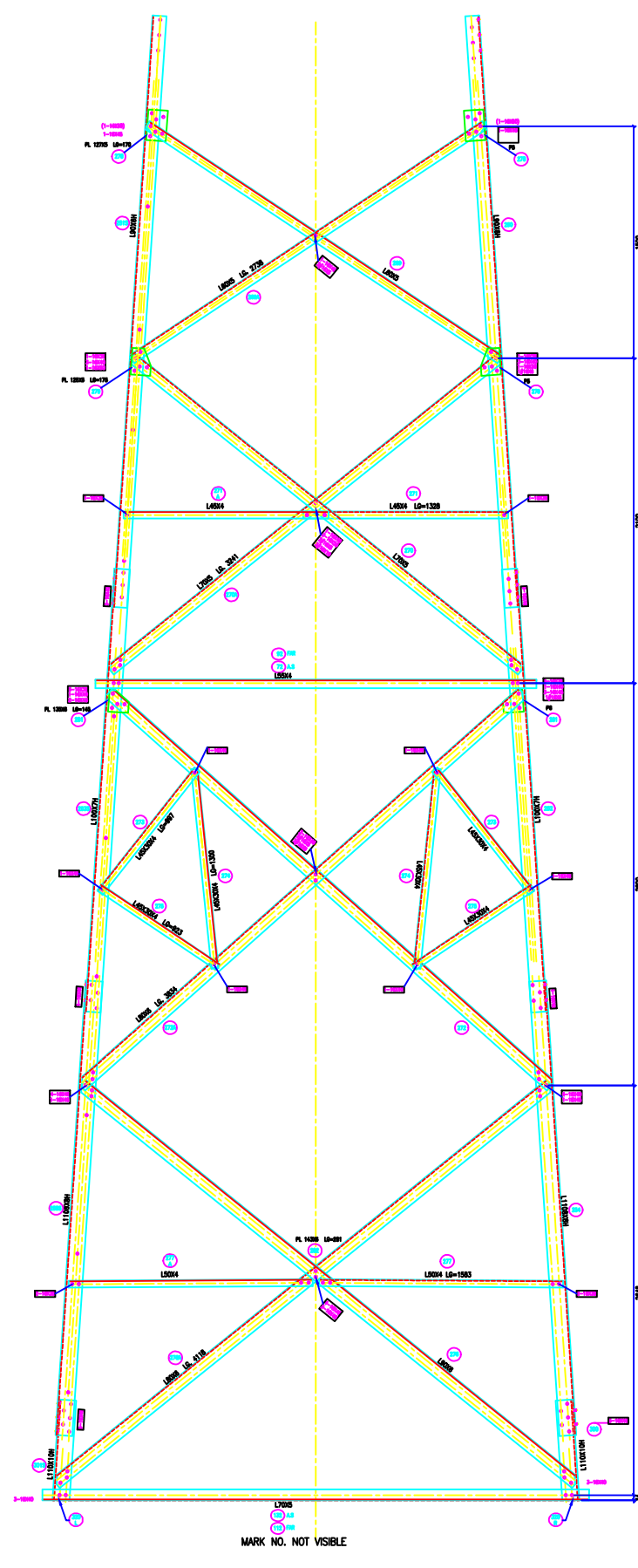
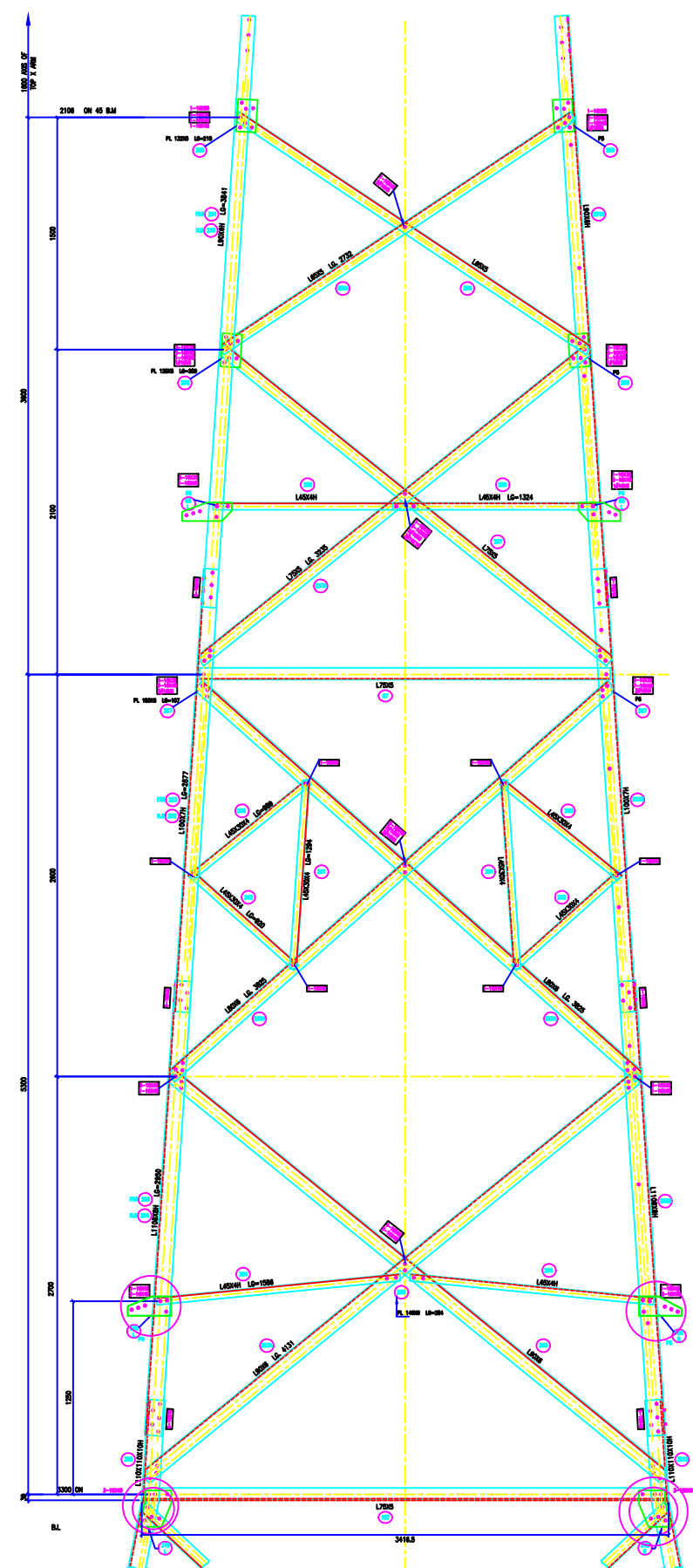

BOLTS AND NUTS STATEMENT

TYPE	SIZE (M.M)	QUANTITY
B	# 16X35	70
C	# 16X40	196
D	# 16X45	126
E	# 16X50	16
F	# 16X55	-
G	# 16X60	-
H	# 16X65	-
J	# 16X70	-
K	# 16X75	-
L	# 16X80	-
SPRING WASHERS		408
30 O.D PACKING WASHERS # 17.5 MM		
	5 mm	16
	6 mm	38
	8 mm	-
	10 mm	12
STEP BOLTS #16 mm X 175mm		21

- GENERAL NOTES:**
- ALL DIMENSIONS ARE IN MM UNLESS OTHERWISE SPECIFIED.
 - MILD STEEL BOLT AND NUTS TO IS 4026/15437/3.9 QTY
 - ALL MILD STEEL BOLT AND NUTS ARE TO BE HOT DIP GALVANIZED AS PER ASTM A153
 - ALL MILD STEEL SECTIONS SHALL BE OF TESTED QUALITY CONFORMING TO IS 2062 STANDARD
 - GALVANIZATION OF TOWER MEMBERS AND FLAT WASHERS AS PER IS 2062
 - ALL HOLES # 16.5mm FOR #16mm BOLTS
 - ALL HOLES # 17.5mm FOR #16mm STEP BOLTS
 - ALL HOLES # 21.5mm FOR #20mm BOLTS
 - ALL HOLES # 17.5mm FOR #16mm STEP BOLTS
 - STANDARD SPRING WASHERS ARE TO BE USED UNDER EACH NUT
 - ALL FABRICATED MEMBERS SHALL HAVE PROFS
 - PROFICATES MEMBERS BEING USED AS STEP BOLTS
 - STEP BOLTS ARE TO BE PROVIDED ON TWO DIAGONALLY OPP. LEGS

MARK NO: 250 + 282

BIHAR STATE POWER TRANSMISSION COMPANY LTD			
DESCRIPTION	220KV D/C TOWER TYPE "2DC" DETAIL OF CAGE-II	SCALE	-
DRG NO	220KV-D/C-Struct-CageII-34	SHEET NO	1-1
REV.	0	REV.	0

DRAWN BY	
CHECKED BY	
APPROVED BY	