

BAR BENDING SCHEDULE FOR FOUNDATION									
MARK No.	SHAPE OF THE BAR	DIA (mm)	LENGHT (mm)	Nos. Leg	Unit Wt. (kg/m)	Wt./Leg. (kg)	Wt./Tower (kg)		
A		12	3920	56	0.888	194.934	779.736		
B		12	2274	14	0.888	28.270	113.080		
C		12	4144	34	0.888	125.116	500.464		
D		20	3350	16	2.466	132.178	528.712		
E		8	1550	13	0.390	7.86	31.434		
F		8	1138	13	0.390	5.77	23.10		
G		8	1110	26	0.390	11.25	45.02		
<b>TOTAL REINFORCEMENT</b>							<b>2021.55</b>		

TYPE OF TOWER : DD+3/6/9

TOWER SLOPE TAN ALPHA = 0.18403

LEVEL	STUB	CG OF STUB	P	M	N	CLEAT DETAILS
+3M	HT130*130*10	35.9	9917	10089	14268	MS 90*90*6 NO.OF PAIRS 3 OUTER-290MM INNER-210MM 4 BOLTS/PAIR
+3M	HT130*130*10	35.9	10281	11193	15829	
+3M	HT130*130*10	35.9	11386	12297	17391	

QUANTITIES/TOWER	
EXCAVATION VOLUME	= 223.95 Cu.M
CONCRETE ( 1:1.5:3)	= 21.91 Cu.M
CONCRETE ( 1:3:6)	= 3.23 Cu.M
REINFORCEMENT	= 2021.55 Kgs.

**NOTES:-**

- DRAWING NOT TO SCALE.
- ALL DIMENSIONS ARE IN MM UNLESS OTHERWISE STATED.
- REINFORCED BAR USED Fe 415 CONFORMING TO IS 1786-1985
- MIX PROPERTIES CONFORMING TO IS 456-2000
- CONCRETE MIX USED GRADE M-20 (NOMINAL MIX 1:1.5:3)
- LEAN CONCRETE MIX USED GRADE M-10 (NOMINAL MIX 1:3:6)
- WHENEVER NECESSARY TO CLEAR STUB AND CLEAT STIRRUPS AND BARS ARE TO BE ADJUSTED AT SITE.
- CLEAR COVER TO THE MAIN REINFORCEMENT BARS SHALL BE 50MM UNLESS OTHERWISE SPECIFIED.
- FOR CLEAT AND STUB TEMPLATE DETAILS PLEASE REFER RESPECTIVE STUB DRG.

THE FOUNDATION HAS BEEN DESIGNED FOR THE FOLLOWING PARAMETERS:  
 TYPE OF SOIL : PS  
 UNIT WEIGHT : 1440/940 Kg/Cu.M  
 BEARING CAPACITY : 13675 Kg/Sq.M  
 ANGLE OF REPOSE : 30/15 Degrees  
 WATER TABLE : 0.75M TO 1.5M BELOW G.L

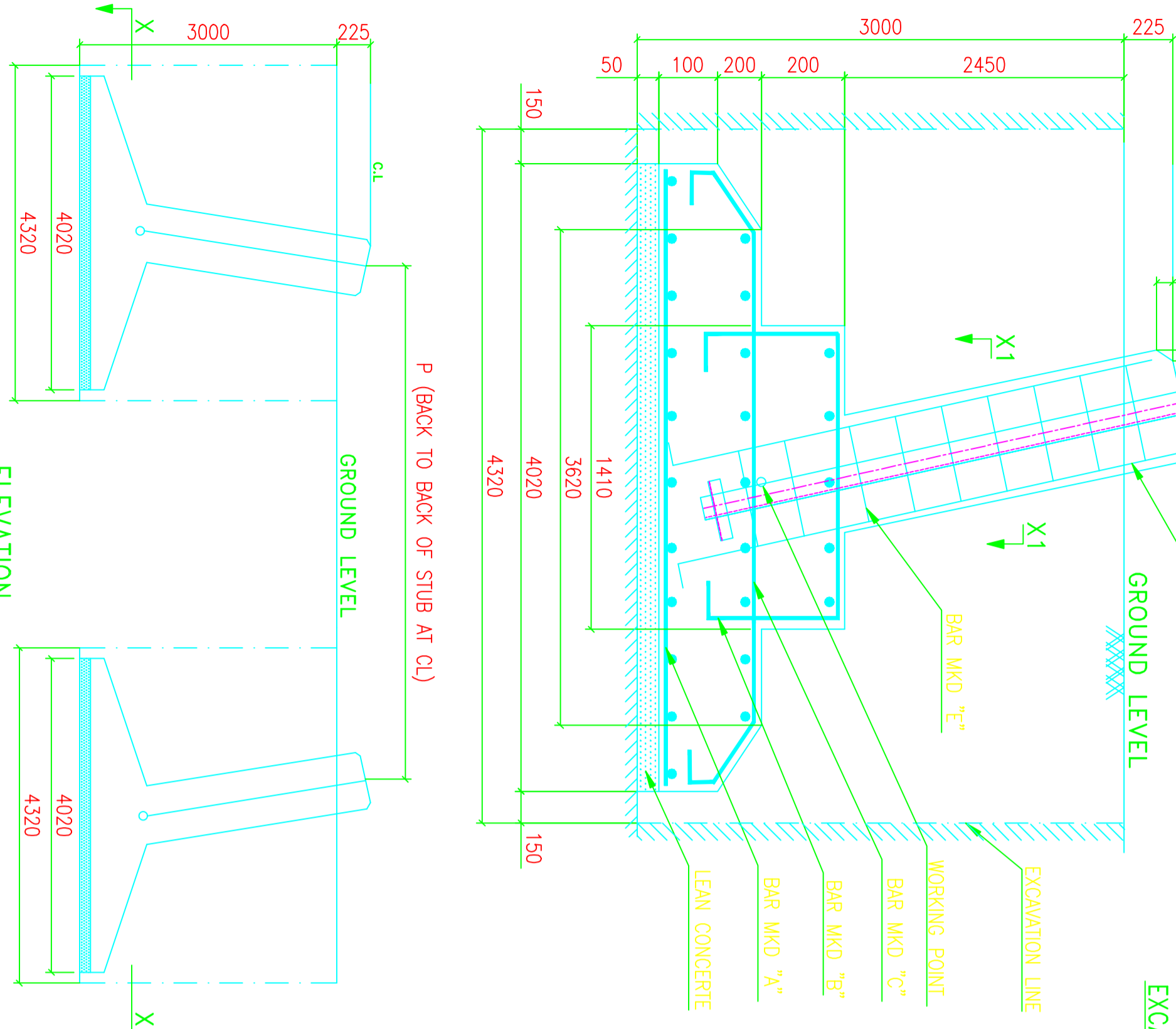

**ELEVATION**

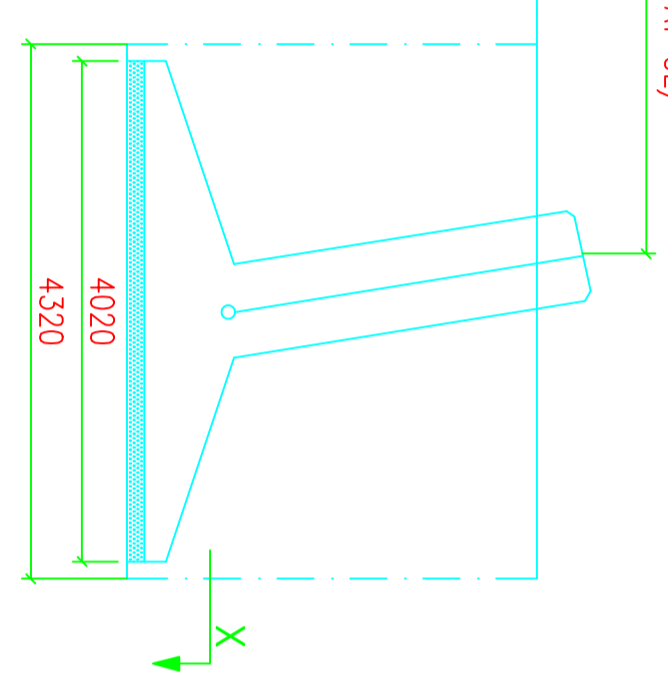

DESCRIPTION	DRG NO	SCALE
132KV D/C "DD+3/6/9" TOWER FOUNDATION DRAWING OF TYPE - PS	132KV-D/C-+3/6/9-Fdn-PS-43	-

BIHAR STATE POWER TRANSMISSION COMPANY LTD