

TOWER SLOPE

Top B	= 0.100400
2 Top B	= 0.200800
Face	= 1.016000
Dev	= 1.000111
In Face Slope	
Top B	= 0.100400
2 Top B	= 0.200800

- GENERAL NOTES:**
1. ALL DIMENSIONS ARE IN MM UNLESS OTHERWISE STATED.
 2. WELD STEEL BOLTS & NUTS TO IS 6032/12427/4.6/5.6 Q17.
 3. ALL WELD STEEL BOLTS & NUTS ARE TO BE HOT DIP GALVANIZED AS PER IS 1207 PART-III.
 4. ALL WELD STEEL BOLTS & NUTS ARE TO BE QUALITY CONFORMING TO IS. 2042 STANDARD.
 5. GALVANIZATION OF TOWER MEMBERS AND PLATE WORKERS AS PER IS. 2033.
 6. ○ ALL BOLTS #17.5 FOR M16 BOLTS U.S.S.
 7. ⊙ ALL BOLTS #21.5 FOR M20 BOLTS U.S.S.
 8. ● ALL BOLTS #17.5 FOR M16 STEP BOLTS U.S.S.
 9. STANDARD SPRING WASHERS ARE TO BE USED UNDER EACH NUT.
 10. ALL FABRICATED MEMBERS SHALL HAVE THE FINISH... 100
 11. STEP BOLTS ARE TO BE PROVIDED ON TWO OPPOSITELY OPPOSED SIDS
 12. (B) INDICATED HIGH TENSILE STEEL CONFORMING TO IS 2062 Q-100 Q17.

LIST OF BOLTS, NUTS & WASHERS

SIZE	QTY.
M16x35 LG. BOLT	108
M16x40 LG. BOLT	152
M16x45 LG. BOLT	108
M16x50 LG. BOLT	24
M16x55 LG. BOLT	84
3.5 THK SP. WASHER	450
PACK WASHER 6MM THK.	10
PACK WASHER 12MM THK.	8
M16x175 LG. STEP BOLT	16

MARK Nos. 1200 TO 1238

BIHAR STATE POWER TRANSMISSION COMPANY LTD

DESCRIPTION	132KV D/C TOWER TYPE "DD" +12.0M BODY EXTENSION (BOTTOM 6M)		SCALE	-
DRG NO	132KV-D/C-Struct-±12M-Body-Extn-412	SHEET NO 1-1	REV.	0

DRAWN BY
CHECKED BY
APPROVED BY

**+12M BODY EXTENSION (ELEVATION)
(BOTTOM +6M)**

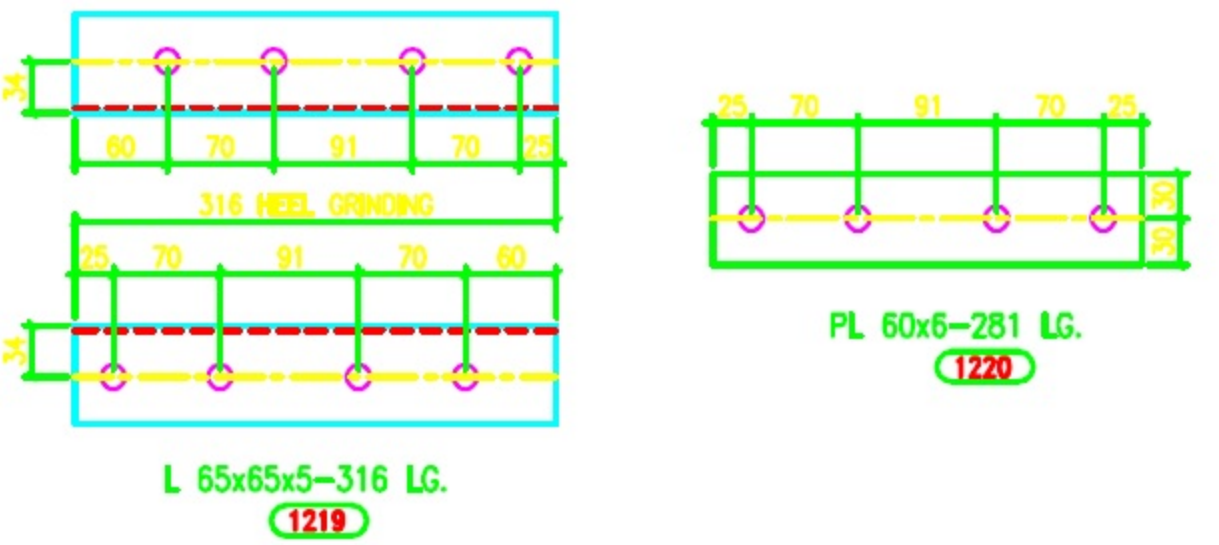
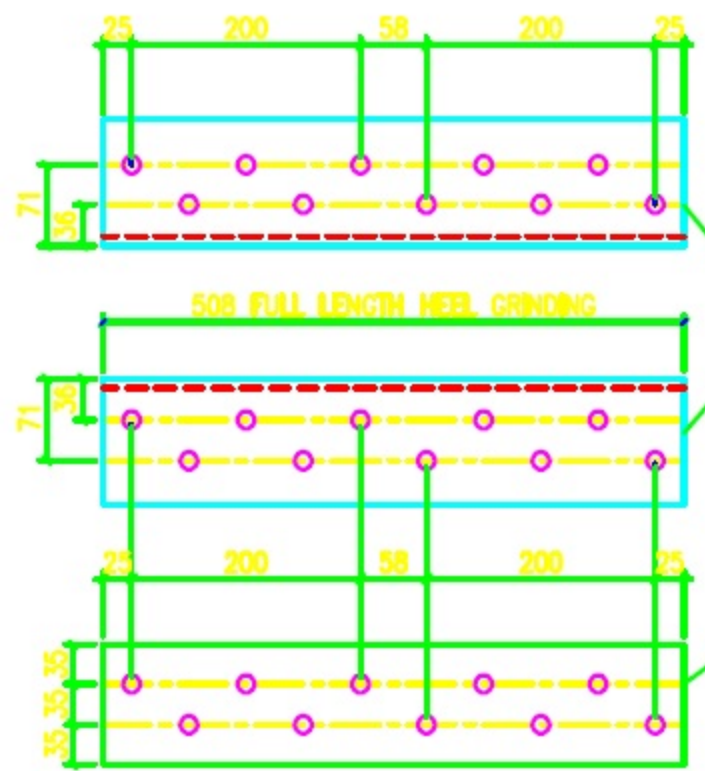

VIEW AT 2-2

VIEW AT 1-1

KEY PLAN