

SECTION J1-J1

+12M BODY EXTENSION (ELEVATION)  
(BOTTOM +6M)

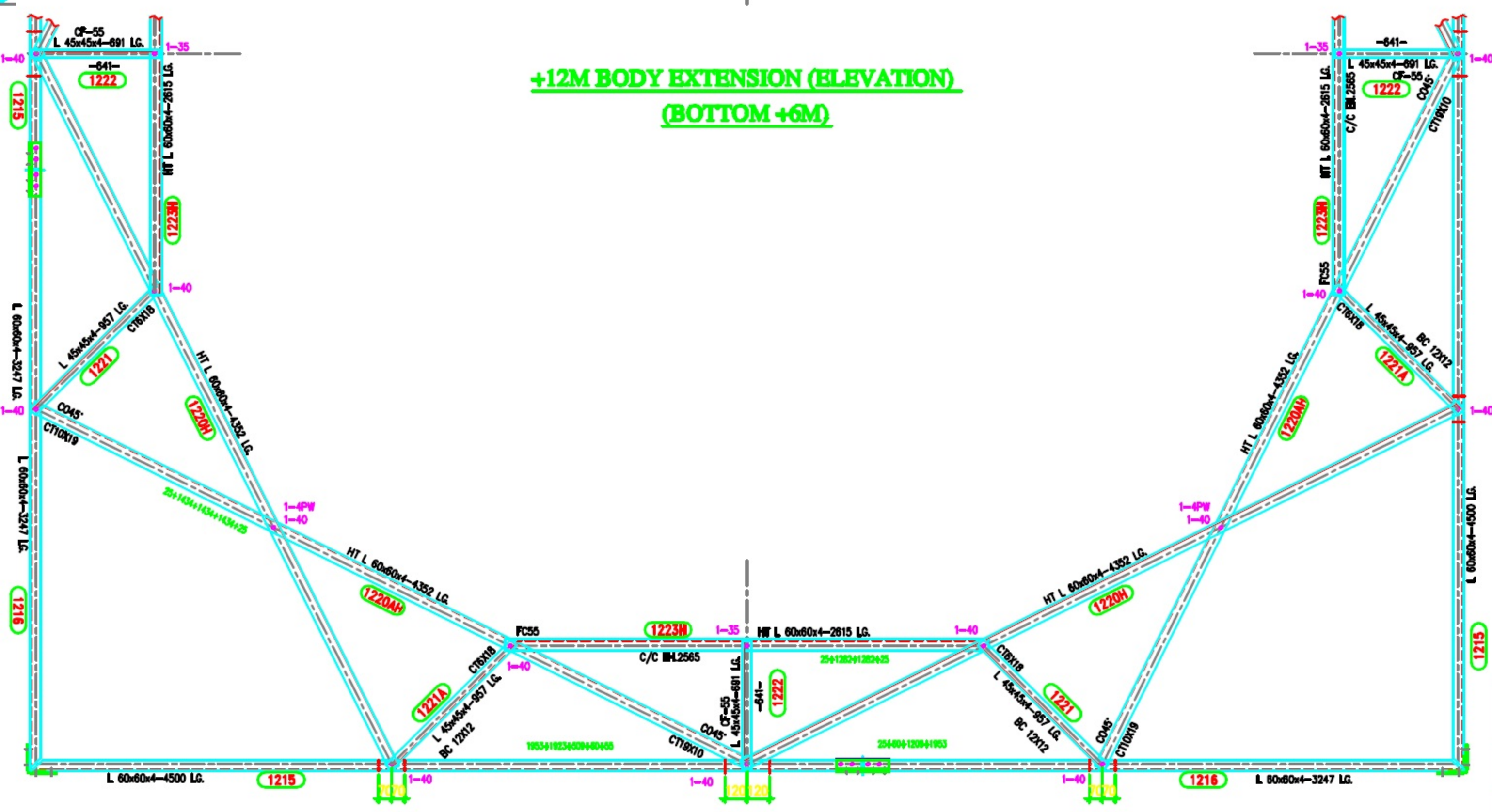

VIEW AT 2-2

LIST OF BOLTS, NUTS & WASHERS

SIZE	QTY.
M16x35 LG. BOLT	124
M16x40 LG. BOLT	244
M16x45 LG. BOLT	48
M16x50 LG. BOLT	48
3.5 THK SP. WASHER	484
PACK WASHER 4MM THK	20
PACK WASHER 5MM THK	12
PACK WASHER 10MM THK	8
M16x175 LG. SSB BOLT	14

TOWER SLOPE

Tan B	= 0.142771
2 Tan B	= 0.285542
Push	= 1.019148
Dist	= 1.029188

In Power Slope

Tan B	= 0.141335
Sec B	= 1.029188

MARK Nos. 1200 TO 1230

VIEW AT 1-1

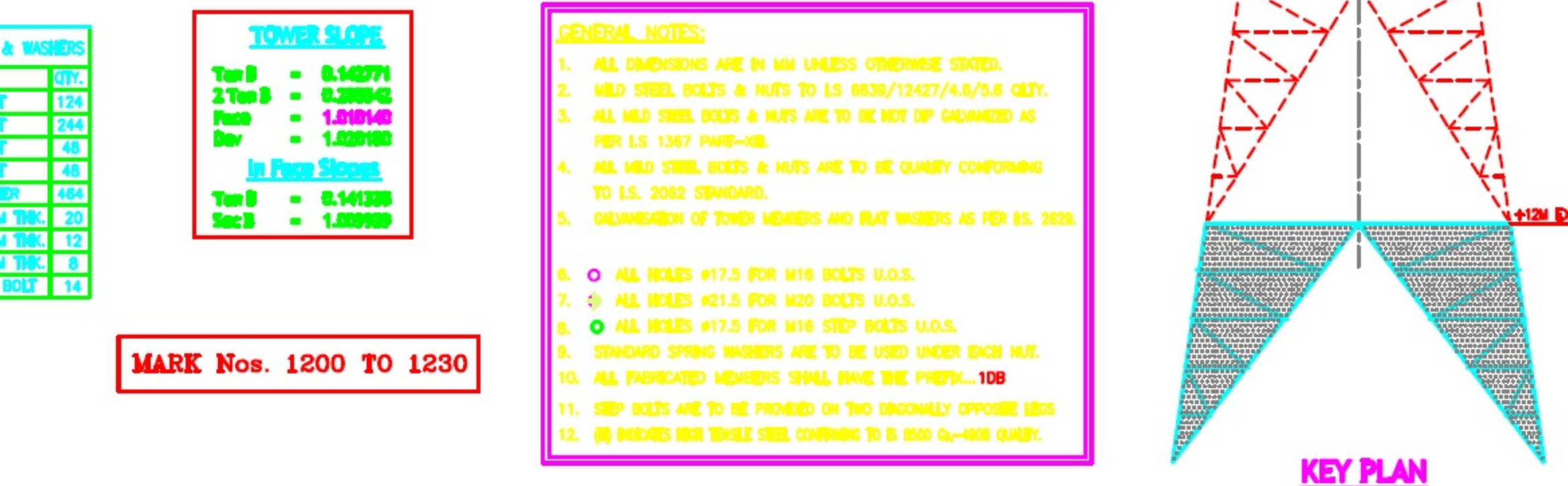

KEY PLAN

- GENERAL NOTES:
- ALL DIMENSIONS ARE IN MM UNLESS OTHERWISE STATED.
  - WELD STEEL BOLTS & NUTS TO IS 8033/12427/4.8/5.8 Q235.
  - ALL WELD STEEL BOLTS & NUTS ARE TO BE HOT DIP GALVANIZED AS PER IS 1347 PART-08.
  - ALL WELD STEEL BOLTS & NUTS ARE TO BE QUANTITY CONFORMING TO IS 2002 STANDARD.
  - DRAWING OF TOWER MEMBERS AND PLAT NUMBERS AS PER IS 2002.
  - ALL BOLTS #17.5 FOR M16 BOLTS U.O.S.
  - ALL BOLTS #21.5 FOR M20 BOLTS U.O.S.
  - ALL BOLTS #17.5 FOR M16 STEP BOLTS U.O.S.
  - STANDARD SPRING WASHERS ARE TO BE USED UNDER EACH NUT.
  - ALL FABRICATED MEMBERS SHALL HAVE THE PROFF... 10B
  - STEP BOLTS ARE TO BE PROVIDED ON TWO OPPOSITELY OPPOSITE SIDS
  - ALL BOLTS WITH SHALL BEEL CHIPPING TO 5 MM O-400 QUANT.

BIHAR STATE POWER TRANSMISSION COMPANY LTD

DRAWN BY	DESCRIPTION	132KV D/C TOWER TYPE "DB" +12M BODY EXTN. AT ±6M LEVEL & BODY EXTN.		SCALE
CHECKED BY	DRG NO	132KV-D/C-Struct-+12M-Extn-211	SHEET NO 1-1	REV. 0
APPROVED BY				