

TOWER SLOPE
(FOR ±0M TOWER)

Tan B	=	0.097605410
2 Tan B	=	0.195210830
Face	=	1.004733381
Dev	=	1.009481860

In Face Slopes

Tan B	=	0.097143771
Sec B	=	1.003962122

REF. +9M
BODY EXTN.
TOP PART

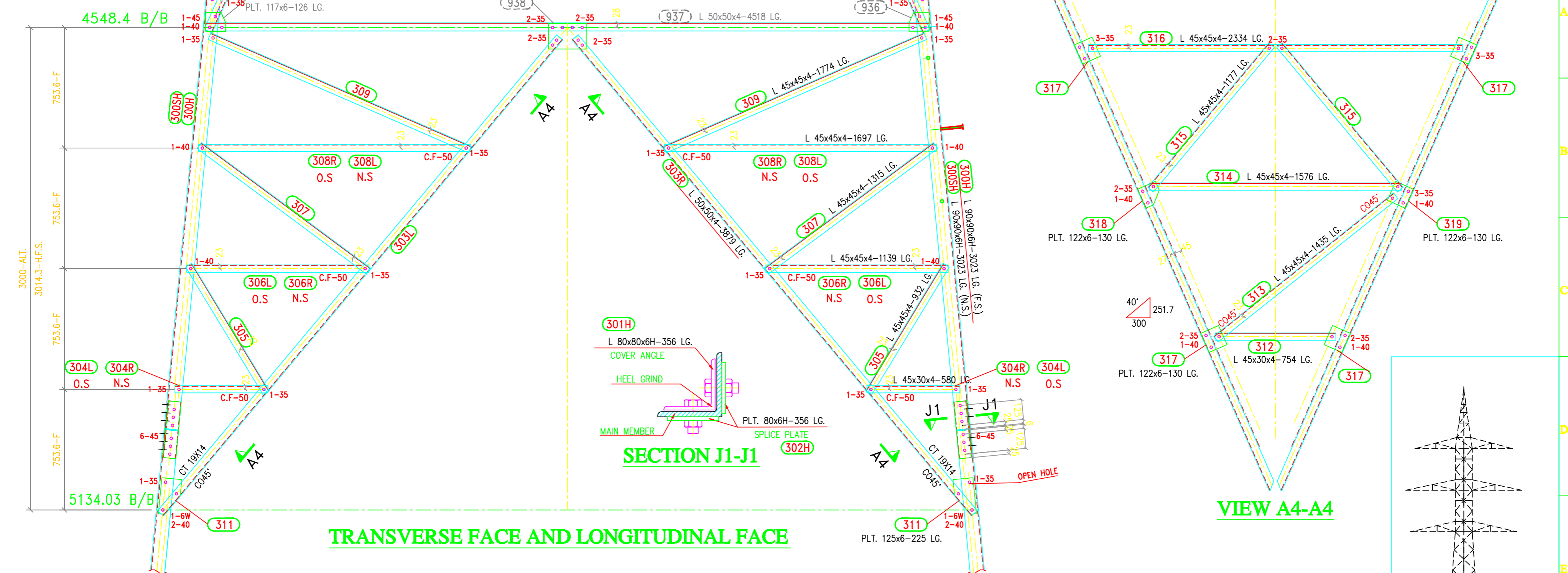

SUMMARY OF BOLTS FOR +3M BODY EXTENSION

BOLT SIZE	QUANTITY	GRADE	REMARKS
16φ x 35 LG	160	5.6	-
16φ x 40 LG	52	5.6	-
16φ x 45 LG	53	5.6	-
16φ x 50 LG	-	5.6	-
16φ x 55 LG	-	5.6	-
16φ x 60 LG	-	5.6	-
16φ x 65 LG	-	5.6	-
16φ x 3.5 THK	265	-	SPRING WASHERS
16φx175 LG.	8	4.6	STEP BOLT
4THK. WASHER	-	-	PACK WASHERS
6THK. WASHER	8	-	PACK WASHERS
8THK. WASHER	-	-	PACK WASHERS
10THK. WASHER	-	-	PACK WASHERS

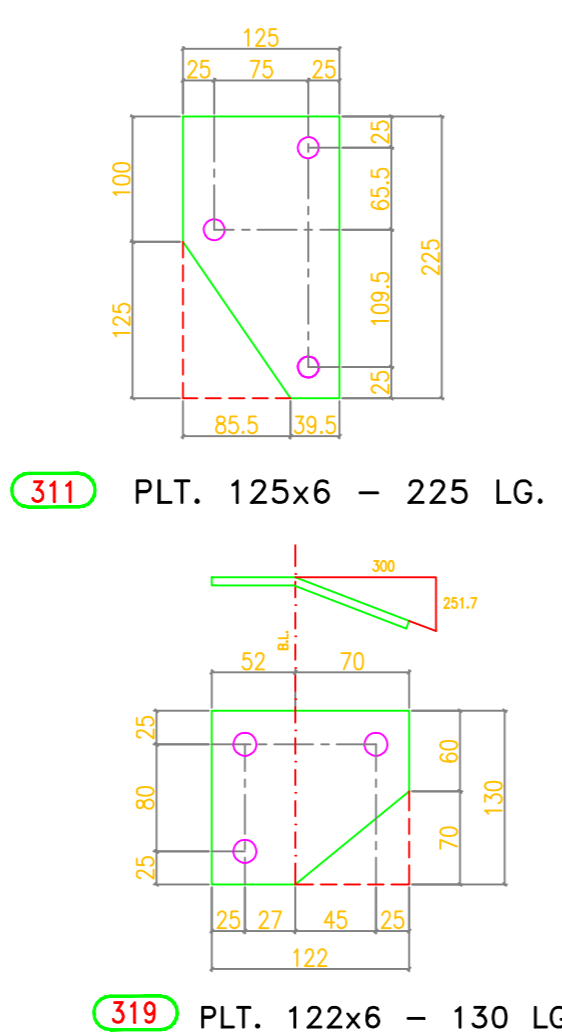

GENERAL NOTES :

- ALL DIMENSIONS ARE IN "mm" UNLESS OTHERWISE SPECIFIED.
- ALL ERECTION MARKS ARE TO BE PREFIXED WITH - "1DA"
- INDICATES Ø17.5 HOLE FOR M16 BOLT U.O.S.
- STRUCTURAL STEEL SHALL BE AS FOLLOWS
 - (i) MILD STEEL - IS:2062 WITH YIELD STRESS $F_y=2550$ KG/SQ.CM.
 - (ii) HIGH TENSILE STEEL - IS:8500 GR490B
- BOLTS AND NUTS AS PER IS:12427 - 1988. CONFORM TO GRADE-5.6
- GALVANISING SHALL CONFORM TO IS:2629-1985 & IS:4759-1987
- SPRING WASHER SHALL BE CONFIRM TO IS 3063-1994
- STEP BOLTS SHALL BE DIAGONALLY OPPOSITE LEGS
- STEP BOLTS SHALL BE IS:10238-1982
- SUFFIX "H" INDICATES HIGH TENSILE STEEL

MARK Nos. 300 TO 319 MARK Nos. 310 NOT USED

BIHAR STATE POWER TRANSMISSION COMPANY LTD

DRAWN BY	DESCRIPTION	132KV D/C TOWER TYPE "DA"		SCALE
CHECKED BY		+3M BODY EXTENSION		-
APPROVED BY	DRG NO	132KV-DC-Struct-+3M-Extn-16	SHEET NO 1-1	REV. 0