

**TOWER SLOPE (FOR 30M TOWER)**

Tan B	= 0.097695410
2 Tan B	= 0.195390820
Sec B	= 1.008549771
Dev	= 1.009481860

**In Face Slopes**

Tan B	= 0.095123331
Sec B	= 1.00962122

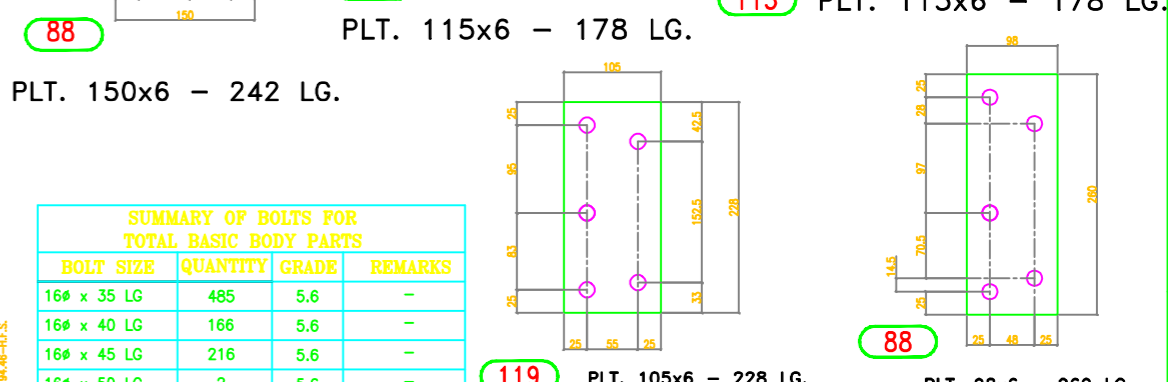
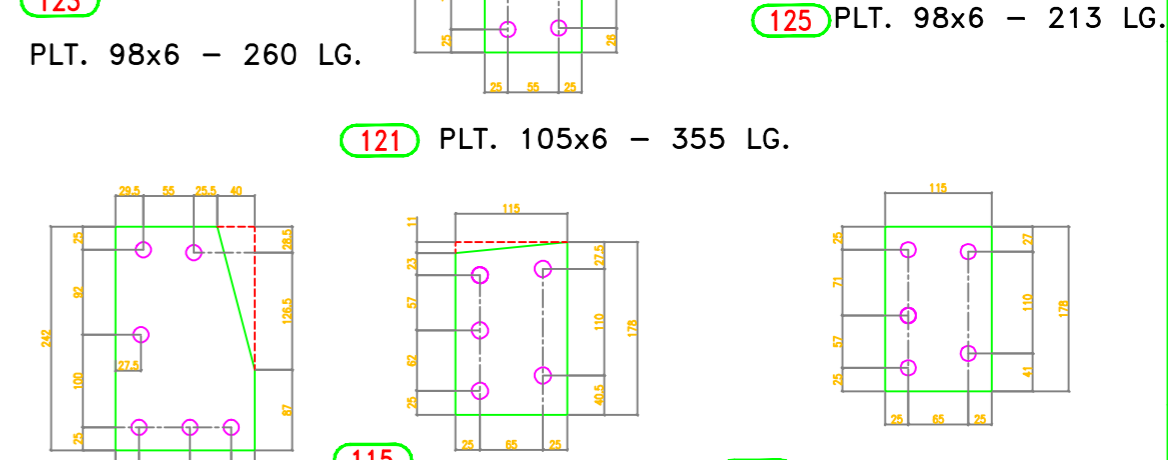
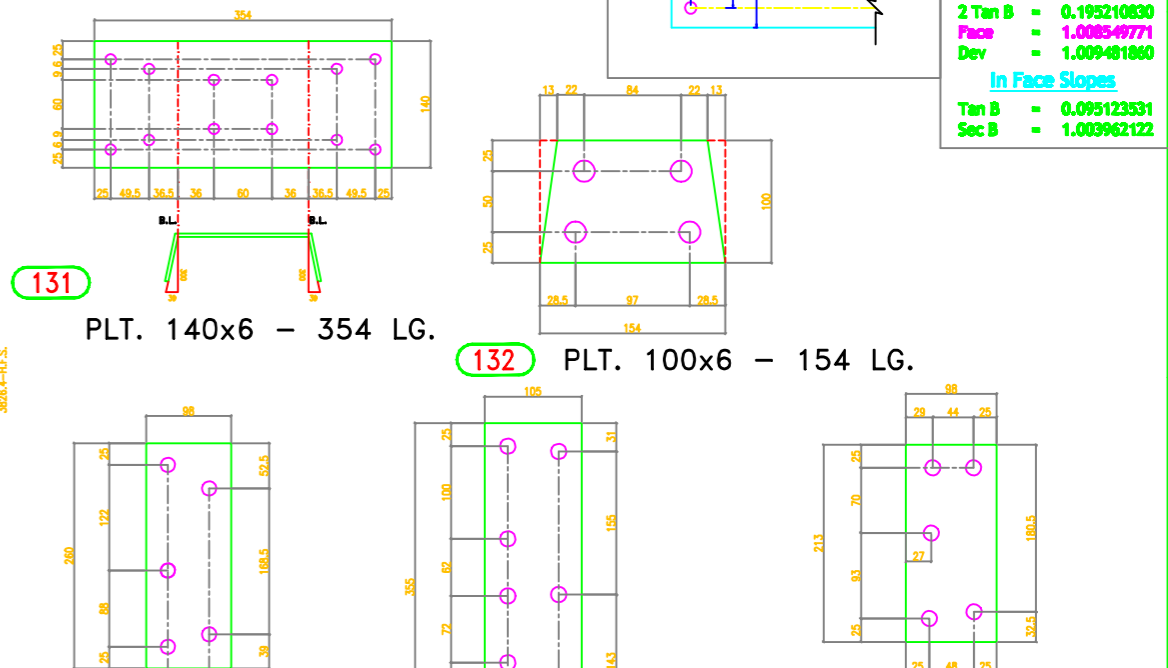
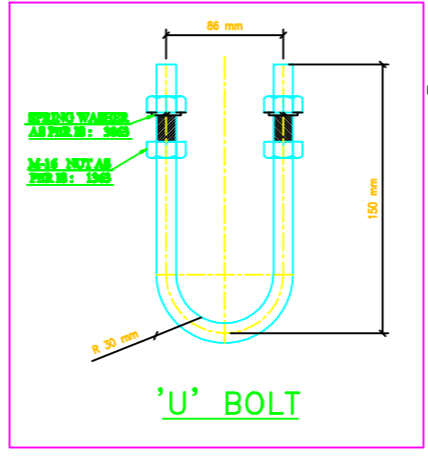
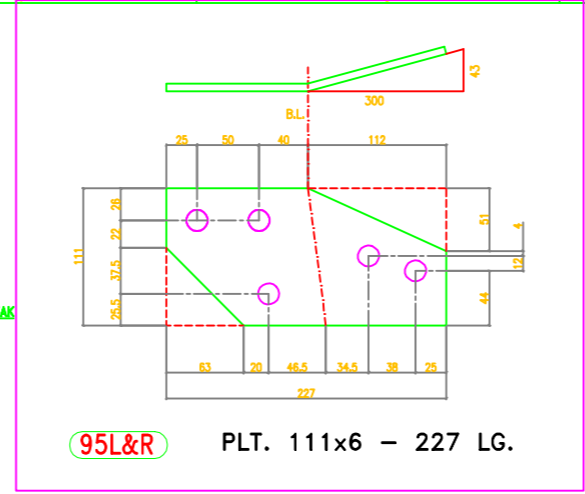

**SUMMARY OF BOLTS FOR TOTAL BASIC BODY PARTS**

BOLT SIZE	QUANTITY	GRADE	REMARKS
16# x 35 LG	485	5.6	-
16# x 40 LG	166	5.6	-
16# x 45 LG	216	5.6	-
16# x 50 LG	2	5.6	-
16# x 55 LG	-	5.6	-
16# x 60 LG	-	5.6	-
16# x 65 LG	-	5.6	-
16# x 3.5 THK	869	-	SPRING WASHERS
16#x175 LG.	88	4.6	STEP BOLT
4THK. WASHER	12	-	PACK WASHERS
5THK. WASHER	22	-	PACK WASHERS
6THK. WASHER	134	-	PACK WASHERS
8THK. WASHER	-	-	PACK WASHERS

**GENERAL NOTES :**

- ALL DIMENSIONS ARE IN "mm" UNLESS OTHERWISE SPECIFIED.
- ALL ERECTION MARKS ARE TO BE PROVIDED WITH - "10A"
- Ø INDICATES #17.5 HOLE FOR 16# BOLT U.G.O.S.
- STRUCTURAL STEEL SHALL BE AS FOLLOWS  
(1) MILD STEEL - IS2062 WITH YIELD STRESS fy=250 KG/SQ.CM.  
(2) HIGH TENSILE STEEL - IS8000 GR40B
- BOLTS AND NUTS AS PER IS:12427 - 1988, CONFORM TO GRADE-5.6
- GAUANCING SHALL CONFORM TO IS:2029-1985 & IS:4759-1996.
- SPRING WASHER SHALL BE CONFORM TO IS 3063-1994
- STEP BOLTS SHALL BE DIAGONALLY OPPOSITE LEGS
- STEP BOLTS SHALL BE IS:10238-1982
- SUFFIX "H" INDICATES HIGH TENSILE STEEL

MARK Nos. 66 TO 136 MARK Nos. 127 & 128 NOT USED

**BIHAR STATE POWER TRANSMISSION COMPANY LTD**

DRAWN BY	DESCRIPTION	132KV D/C TOWER TYPE "DA" BASIC BODY - II	SCALE	-
CHECKED BY	DRG NO	132KV-D/C-Struct- Body-II-14	SHEET NO	1-1
APPROVED BY	REV.	0		