

VERTICAL SLOPE
 TAMB = 0.200461
 ZTAMB = 0.400922
 FACE = 1.019895
 DEVELOP = 1.039408

IN FACE SLOPE
 TAMB = 0.196551
 ZTAMB = 1.019133

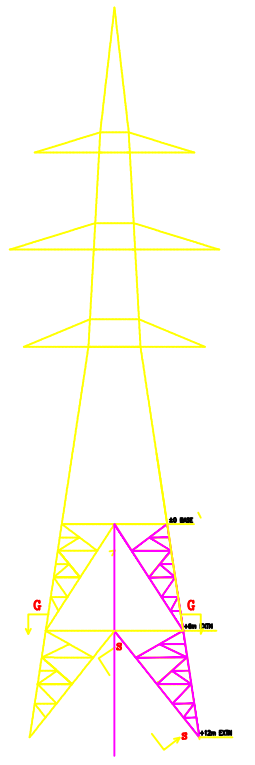
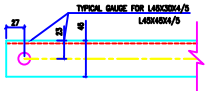
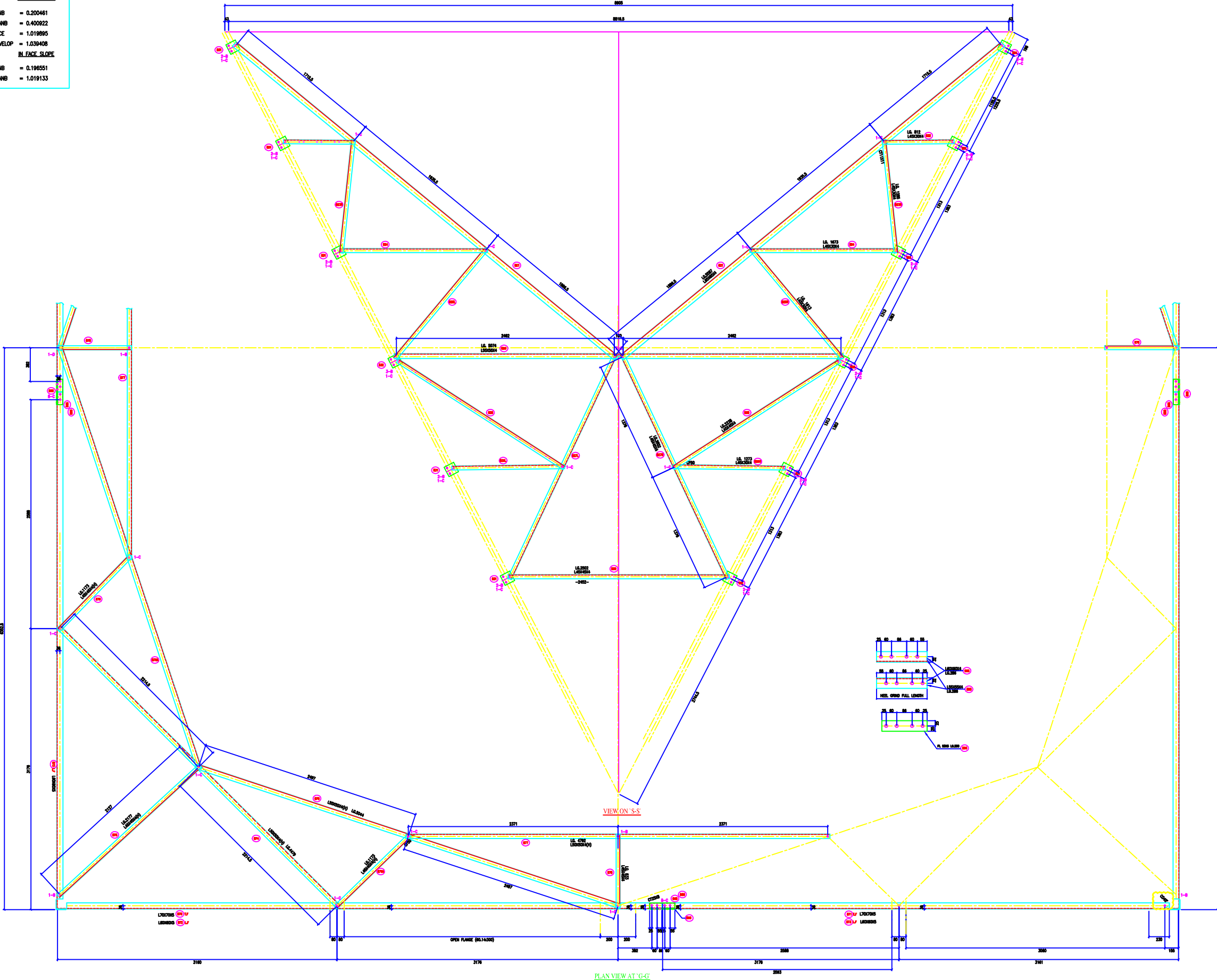

BOLTS AND NUTS STATEMENT

TYPE	SIZE (IN MM)	QUANTITY	
		+12m EXTN	PLAN VIEW
B	# 16X35	8	8
C	# 16X40	32	32
D	# 16X45	4	4
E	# 16X50	-	-
F	# 16X55	-	-
G	# 16X60	-	-
H	# 16X65	-	-
J	# 16X70	-	-
K	# 16X75	-	-
L	# 16X80	-	-
SPRING WASHERS		64	64
30 O.D PACKING WASHERS # 17.5 MM		-	-
5 mm		-	-
6 mm		-	-
8 mm		-	-
10 mm		-	-
STEP BOLTS #16 mm X 175mm		-	-

- GENERAL NOTES:**
1. ALL DIMENSIONS ARE IN MM UNLESS OTHERWISE SPECIFIED.
 2. MILD STEEL BOLT AND NUTS TO BS4340/12427/8.8 QLT
 3. ALL MILD STEEL BOLT AND NUTS ARE TO BE HOT DIP GALVANIZED AS PER ASTM A153
 4. ALL MILD STEEL SECTIONS SHALL BE OF TESTED QUALITY CONFORMING TO IS 2062 STANDARD
 5. GALVANIZATION OF TOWER MEMBERS AND FLAT WASHERS AS PER IS 2029
 6. ALL HOLES # 15.5mm FOR #12mm BOLTS
 7. ALL HOLES # 17.5mm FOR #16mm BOLTS
 8. ALL HOLES # 21.5mm FOR #20mm BOLTS
 9. ALL HOLES # 17.5mm FOR #16mm STEP BOLTS
 10. STANDARD SPRING WASHERS ARE TO BE USED UNDER EACH NUT
 11. ALL FABRICATED MEMBERS SHALL HAVE PREFIX
 12. CIRCULATES MEMBERS BEING USED AS STEP BOLTS.
 13. STEP BOLTS ARE TO BE PROVIDED ON TWO DIAGONALLY OPP. LEGS

MARK NO: 821 + 834 865 + 880

BIHAR STATE POWER TRANSMISSION COMPANY LTD

DRAWN BY		DESCRIPTION	220KV D/C TOWER TYPE "2DA" VIEW "S-S" AND DETAIL OF PLAN VIEW "G-G" (+12M EXTN.)	SCALE	-
CHECKED BY		DRG NO	220KV-D/C-Struct-+12M-Extn-110	SHEET NO	1-1
APPROVED BY				REV.	0