

SECTION X1-X1

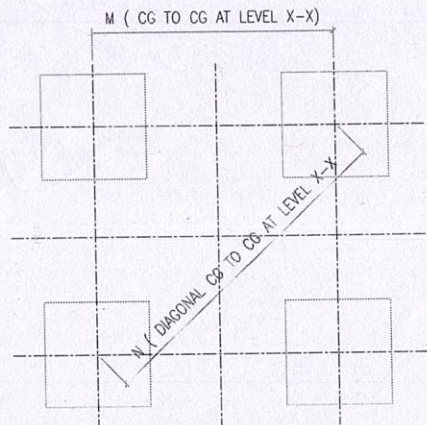

EXCAVATION PLAN AT X-X

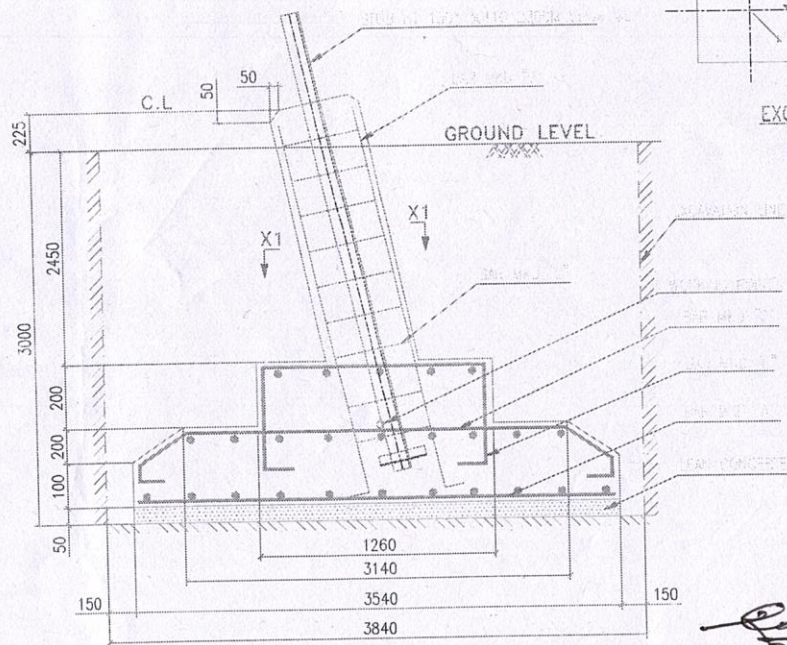

P (BACK TO BACK OF STUB AT CL)

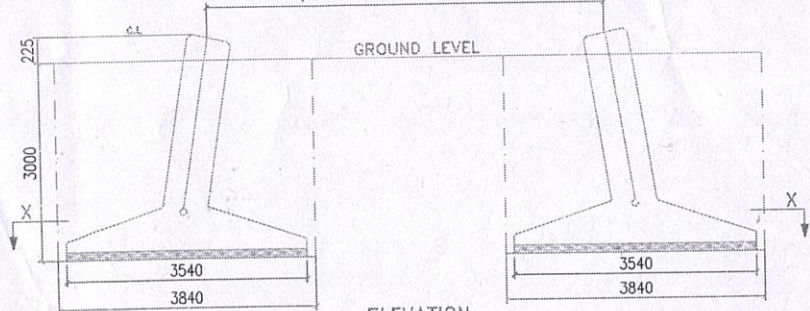

ELEVATION

QUANTITIES/TOWER	
EXCAVATION VOLUME	= 176.95 Cu.M
CONCRETE (1:1.5:3)	= 17.43 Cu.M
CONCRETE (1:3:6)	= 2.51 Cu.M
REINFORCEMENT	= 1710.304 Kgs.

NOTES:
 1. ALL DIMENSIONS ARE IN MM UNLESS OTHERWISE SPECIFIED.
 2. ALL REINFORCEMENT SHALL BE AS PER IS: 4567.
 3. ALL REINFORCEMENT SHALL BE PROVIDED WITH 25MM CLEAR COVER TO THE MAIN REINFORCEMENT UNLESS OTHERWISE SPECIFIED.
 4. FOR CLEAR AND STUB TEMPLATE DETAIL PLEASE REFER TO RELEVANT DRAWING.
 5. ALL DIMENSIONS ARE IN MM UNLESS OTHERWISE SPECIFIED.
 6. ALL REINFORCEMENT SHALL BE AS PER IS: 4567.
 7. ALL REINFORCEMENT SHALL BE PROVIDED WITH 25MM CLEAR COVER TO THE MAIN REINFORCEMENT UNLESS OTHERWISE SPECIFIED.
 8. FOR CLEAR AND STUB TEMPLATE DETAIL PLEASE REFER TO RELEVANT DRAWING.

21-08-19
31-08-2019
31-8-19

BAR BENDING SCHEDULE FOR FOUNDATION							
MARK No.	SHAPE OF THE BAR	DIA (mm)	LENGHT (mm)	Nos. Leg	Unit Wt. (Kg/m)	Wt./Leg. (Kg)	Wt./Tower (Kg)
A	3440	12	3440	50	0.838	152.736	610.944
B	1180	12	2144	14	0.888	26.654	106.616
C	3040	12	3664	28	0.888	91.102	364.408
D	3000	20	3350	16	2.466	132.178	528.712
		28	3350	4	4.834	64.775	259.100
E	350	8	1550	13	0.390	7.86	31.434
F	350	8	1138	13	0.390	5.77	23.10
G	350	8	1110	26	0.390	11.25	45.02
TOTAL REINFORCEMENT							1710.304

TYPE OF TOWER : DD+3/6/9 **1969.334**

TOWER SLOPE TAN ALPHA = 0.18403						
LEVEL	STUB	CG OF STUB	P	M	N	CLEAR DETAILS
+3M	HT 130*130*10	35.9	9917	10089	14268	MS 90*30*6 NO.OF PAIRS 3 OUTER-200MM INNER-210MM 4 BOLTS/PAIR
+3M	HT 130*130*10	35.9	10281	11193	15829	
+3M	HT 130*130*10	35.9	11386	12297	17391	

THE FOUNDATION HAS BEEN DESIGNED FOR THE FOLLOWING PARAMETERS:
 TYPE OF SOIL : WET
 UNIT WEIGHT : 1440/940 Kg/Cu.M
 BEARING CAPACITY : 13675 Kg/Sq.M
 ANGLE OF REPOSE : 30/15 Degrees
 WATER TABLE : 1.5M TO 3.0M BELOW G.L.

BIHAR STATE POWER TRANSMISSION COMPANY LTD

DRAWN BY	DESCRIPTION	132KV D/C "DD+3/6/9" TOWER FOUNDATION DRAWING OF TYPE - WET	SCALE
CHECKED BY	DRG NO	132KV-D/C-+3/6/9-Fdn-Wet-42	REV. 0
APPROVED BY			SHEET NO 1-1